

BAIDOA RESELTMENTS SOLAR STREET LIGHTS



Notes

1. All dimensions are to be checked on site. Any discrepancy in dimensions is to be reported to the architect before any work commences. The Architect's drawings and specifications over rule any other. The Structural Engineers detail drawings.
2. All construction work to comply with the international standards codes protection.
3. The PV denotes permanent ventilation and must be provided above all doors and windows where indicated.
4. All walls less than 200mm thick are to be reinforced with hoop iron sheet every alternate course.
5. All reinforced concrete works to be done according to structural detail drawings

No:	Date:	Description:
REVISION		

Implemented by:



Client:



Project Title:

**PROPOSED OF SOLAR LIGHTS
BAIDOA RESELTMENTS.**

Drawing Title:

Site Location

SCALE: AS SHOWN

DATE: JANUARY 2019

DESIGN & DRAWN BY: **ENG. M.Awil**

REVIEWED BY:

Sheet No.

03

A3

SOLAR LIGHTS POINTS

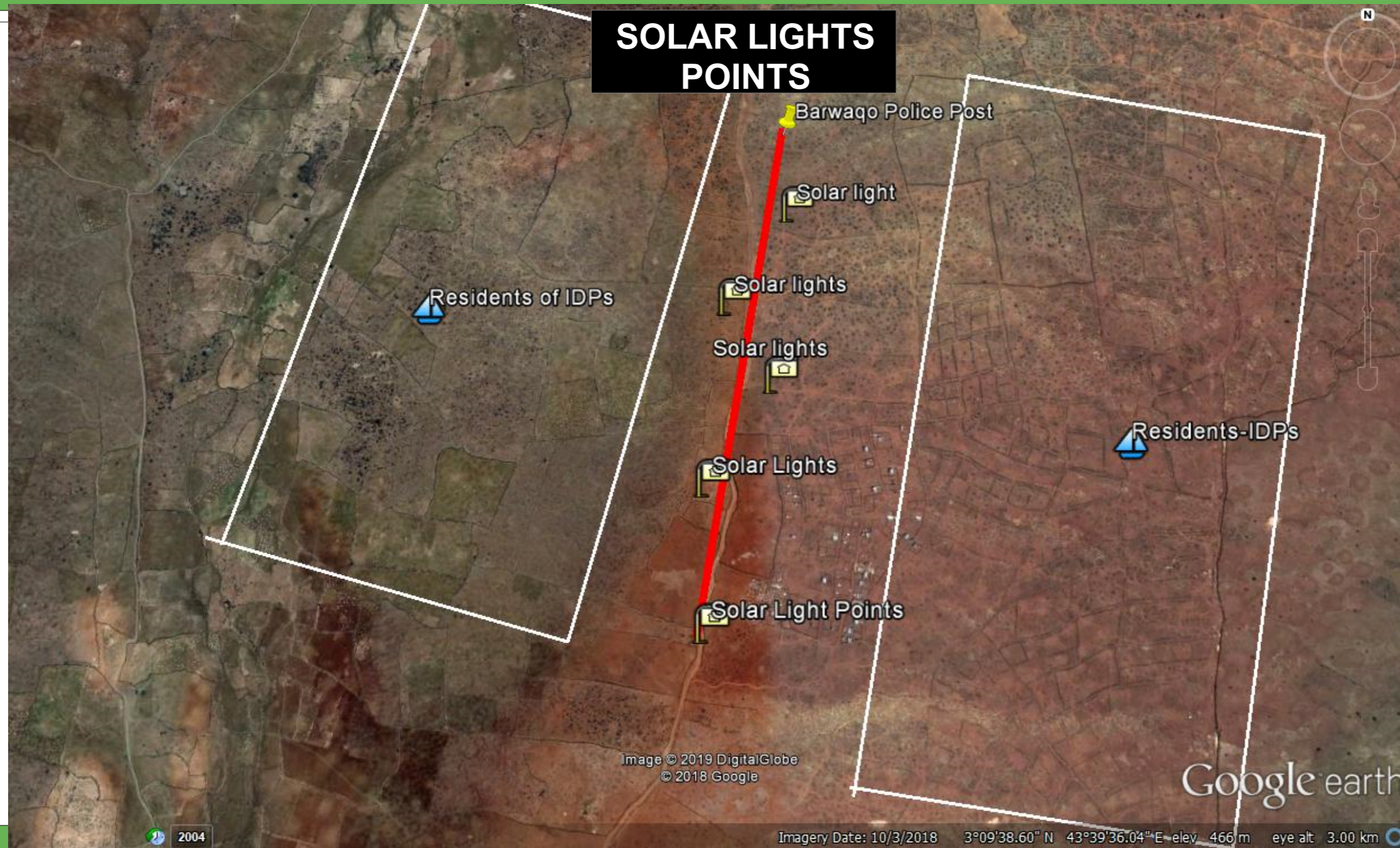

Image © 2019 DigitalGlobe
© 2018 Google

Google earth

Imagery Date: 10/3/2018 3°09'38.60" N 43°39'36.04" E elev 466 m eye alt 3.00 km

2004



Notes

1. All dimensions are to be checked on site. Any discrepancy in dimensions is to be reported to the architect before any work commences. The Architect's drawings and specifications over rule any other. The Structural Engineers detail drawings.
2. All construction work to comply with the international standards codes protection.
3. The PV denotes permanent ventilation and must be provided above all doors and windows where indicated.
4. All walls less than 200mm thick are to be reinforced with hoop iron sheet every alternate course.
5. All reinforced concrete works to be done according to structural detail drawings

No:	Date:	Description:
REVISION		

Implemented by:



Client:



Project Title:

PROPOSED OF BAIDOA SOLAR STREET LIGHTS

Drawing Title:

Site analysis

SCALE:	AS SHOWN
DATE:	JANUARY 2019
DESIGN & DRAWN BY:	ENG. M.Awil
REVIEWED BY:	

Sheet No.

04

A3

Notes

1. All dimensions are to be checked on site. Any discrepancy in dimensions is to be reported to the architect before any work commences. The Architect's drawings and specifications over rule any other. The Structural Engineers detail drawings.
2. All construction work to comply with the international standards codes protection.
3. The PV denotes permanent ventilation and must be provided above all doors and windows where indicated.
4. All walls less than 200mm thick are to be reinforced with hoop iron sheet every alternate course.
5. All reinforced concrete works to be done according to structural detail drawings.

No:	Date:	Description:
REVISION		

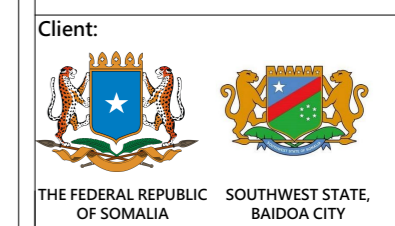

Project Title:
PROPOSED OF BAIDOA SOLAR STREET LIGHTS

Drawing Title:
Solar Points

SCALE: AS SHOWN
DATE: JANUARY 2019
DESIGN & DRAWN BY: **ENG. M.Awil**
REVIEWED BY:

Sheet No.
05
A3

Line-2

Setout Point	Easting	Northing	Casual Position
Line_2_Pt_1	351227	349769	Casual-1
Line_2_Pt_2	351277	349749	Casual-2
Line_2_Pt_3	351323	349729	Casual-3
Line_2_Pt_4	351369	349710	Casual-4
Line_2_Pt_5	351419	349690	Casual-5
Line_2_Pt_6	351465	349671	Casual-6
Line_2_Pt_7	351511	349652	Casual-7
Line_2_Pt_8	351561	349631	Casual-8
Line_2_Pt_9	351608	349612	Casual-9
Line_2_Pt_10	351654	349593	Casual-10
Line_2_Pt_11	351704	349573	Casual-1
Line_2_Pt_12	351750	349553	Casual-2
Line_2_Pt_13	351796	349534	Casual-3
Line_2_Pt_14	351846	349514	Casual-4
Line_2_Pt_15	351892	349495	Casual-5
Line_2_Pt_16	351939	349476	Casual-6
Line_2_Pt_17	351988	349455	Casual-7
Line_2_Pt_18	352035	349436	Casual-8
Line_2_Pt_19	352081	349417	Casual-9
Line_2_Pt_20	352131	349397	Casual-10
Line_2_Pt_21	352177	349377	Casual-1
Line_2_Pt_22	352223	349358	Casual-2



Line-7

Setout Point	Easting	Northing	Casual Position
Line_7_Pt_1	351284	349910	Casual-1
Line_7_Pt_2	351265	349863	Casual-2
Line_7_Pt_3	351246	349817	Casual-3
Line_7_Pt_4	351227	349769	Casual-4

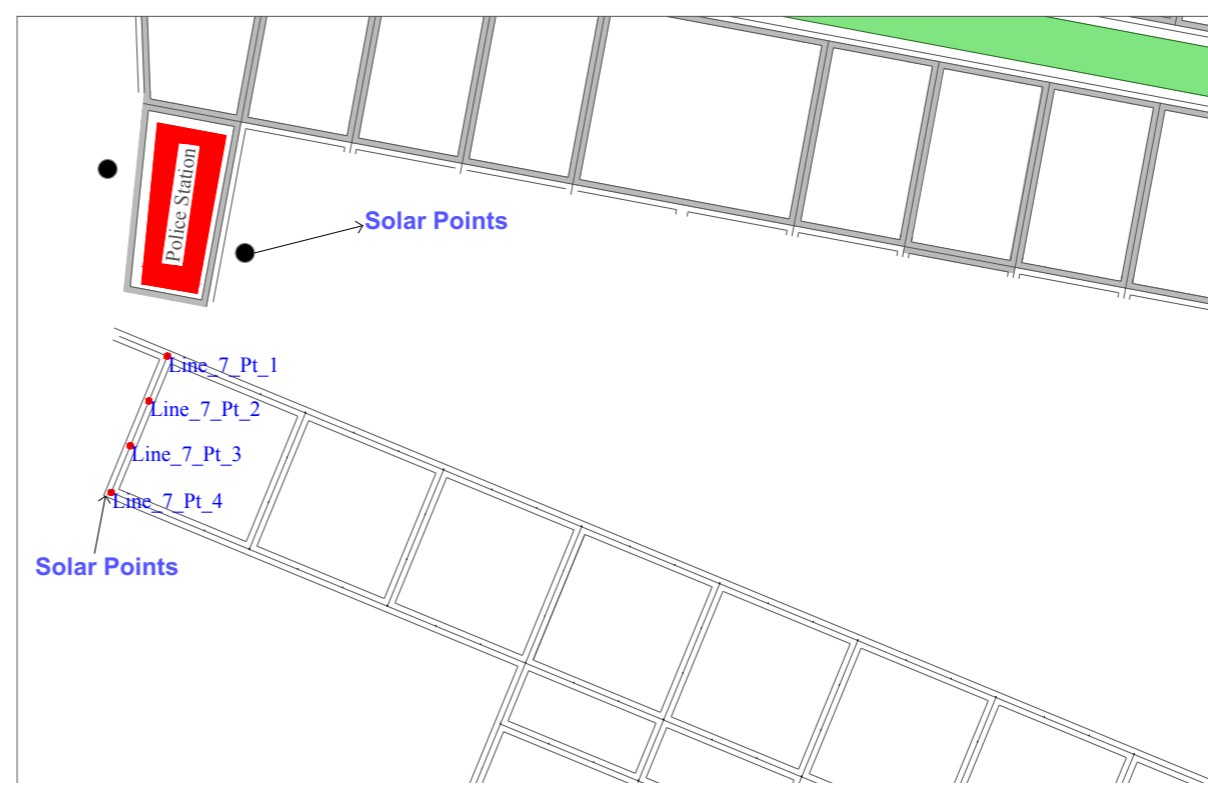

Notes

1. All dimensions are to be checked on site. Any discrepancy in dimensions is to be reported to the architect before any work commences. The Architect's drawings and specifications over rule any other, the Structural Engineers detail drawings.
2. All construction work to comply with the international standards codes protection.
3. The PV denotes permanent ventilation and must be provided above all doors and windows where indicated.
4. All walls less than 200mm thick are to be reinforced with hoop iron sheet every alternate course.
5. All reinforced concrete works to be done according to structural detail drawings.

No:	Date:	Description:
REVISION		

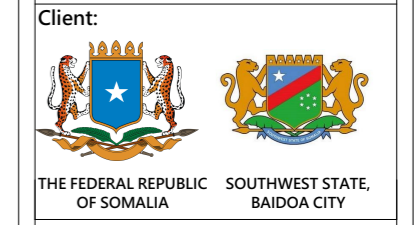

Project Title:
PROPOSED OF BAIDOA SOLAR STREET LIGHTS

Drawing Title:
Transverse section

SCALE: AS SHOWN
 DATE: JANUARY 2019
 DESIGN & DRAWN BY: **ENG. M.Awil**
 REVIEWED BY:

Sheet No.
06
A3

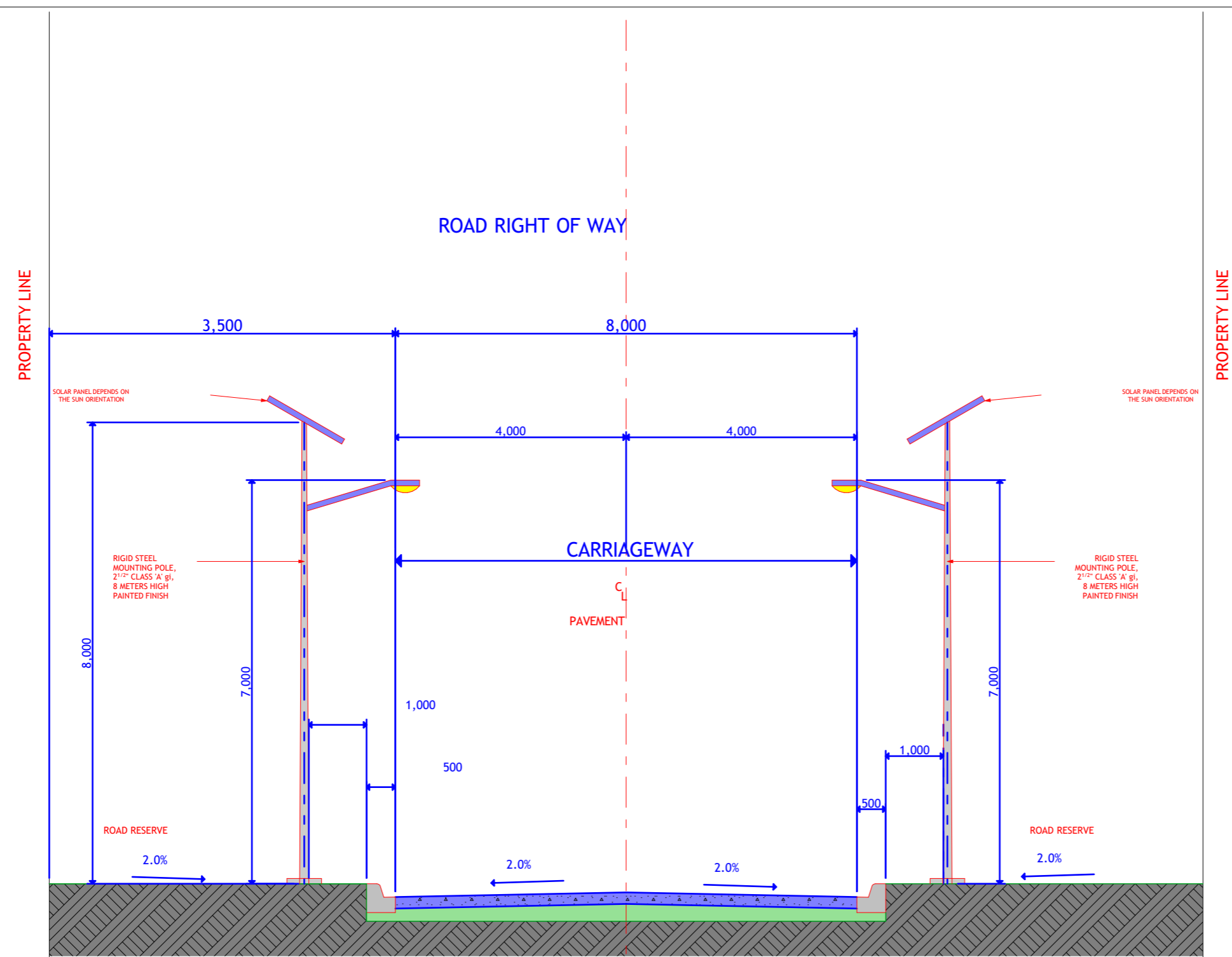

TYPICAL ROAD CROSS - SECTION

Notes

1. All dimensions are to be checked on site. Any discrepancy in dimensions is to be reported to the architect before any work commences. The Architect's drawings and specifications over rule any other. The Structural Engineers detail drawings.

2. All construction work to comply with the international standards codes protection.

3. The PV denotes permanent ventilation and must be provided above all doors and windows where indicated.

4. All walls less than 200mm thick are to be reinforced with hoop iron sheet every alternate course.

5. All reinforced concrete works to be done according to structural detail drawings

No:	Date:	Description:
REVISION		

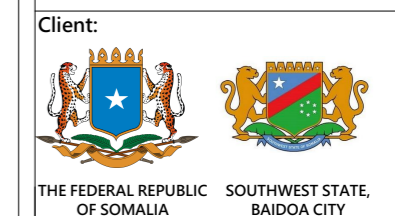

Project Title:
PROPOSED OF BAIDOA SOLAR STREET LIGHTS

Drawing Title:
Specification of Solar lights

SCALE: AS SHOWN
DATE: JANUARY 2019
DESIGN & DRAWN BY: **ENG. M.Awil**
REVIEWED BY:

Sheet No.
07
A3

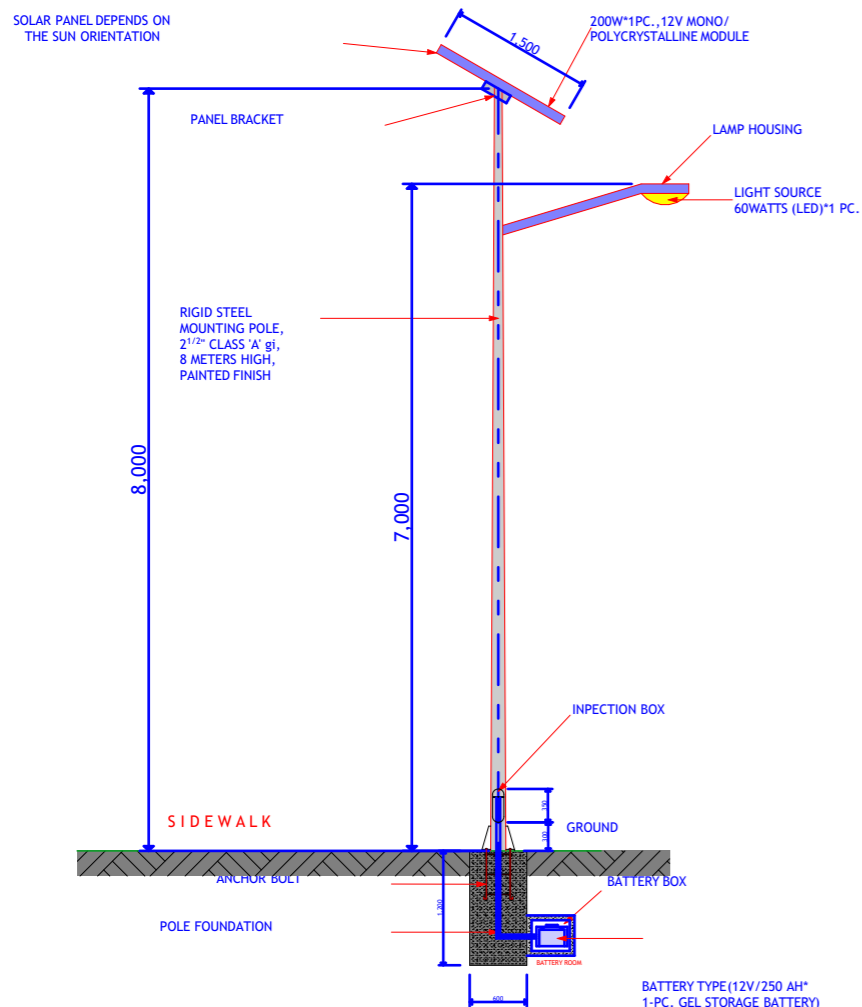

SOLAR LAMP		60W SINGLE LED SOLAR STREET LIGHT SYSTEM SPECIFICATION
ORDINAL NUMBER	COMPONENTS	PARAMETER GENERAL SITUATION
01	SOLAR PANEL	200W*1PC. MONO/POLYCRYSTALLINE SILICON
02	BATTERY	12V/250AH*1-PC. GEL STORAGE BATTERY
03	LIGHT SOURCE SOCKET	60WATTS (LED) * ONE(1) PC.
04	CONTROLLER	24VOLTS/20AMPERES
05	TEMPERATURE	-40 - 50 DEGREE CELSIUS
06	LIGHTING TIME	3 RAINY DAYS, EVERYDAY 12 HOURS
07	HEIGHT	EIGHT METERS (8M)
08	BATTERY BOX (PLASTIC)	ONE(1) SET (TO BE PUT UNDERGROUND)
09	ACCESSORIES, CABLE, ETC.	ONE(1) SET

SOLAR STREET LIGHT

(AS PER MANUFACTURER'S DETAILS)